

NAUTRONIC SCOREBOARD SYSTEM

Danmarksvej 1
DK-8660 Skanderborg
Tel: +45 86 51 11 66
scoreboards@nautronic.com
nautronic.com

The entire guide is subject to alterations



NAUTRONIC
SCOREBOARD SYSTEM

NAUCON-10

 *User Guide*

 *Brugervejledning*





Getting to know your Naucon-10

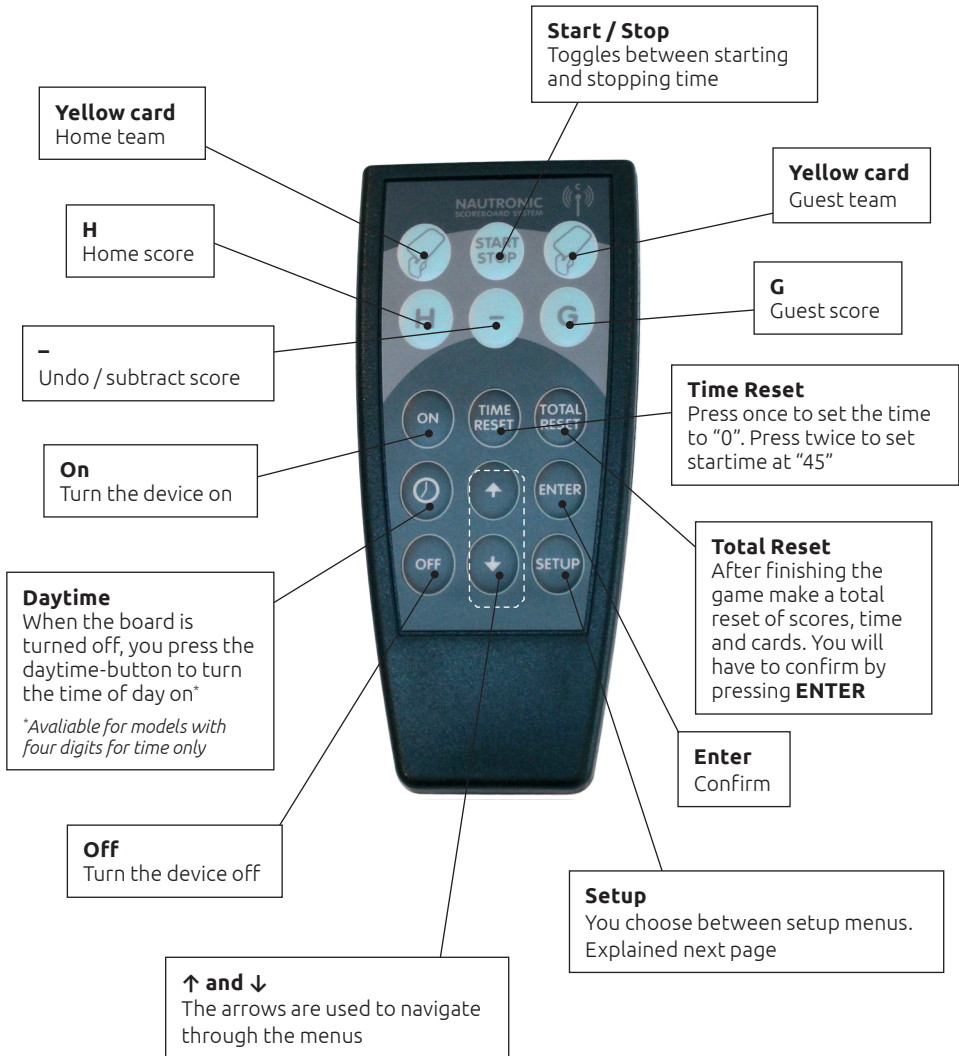

RESTORE FACTORY SETTINGS

Press **SETUP** twice. The scoreboard's digits will display as "8". Press **ENTER** to confirm the factory settings to be restored. Press any other key to abort.



Setup menus

How to enter the Setup menus

Press **SETUP** and then **ENTER** to go to Setup menu.

Choose between the 6 menus; use the arrows to navigate the menus. Press **ENTER** to confirm your choice of menu.

Menu 1: Game clock counting up or down

Use the arrows to change whether the time is going to count up or down*. Press **ENTER** to confirm.

“0” time is counting up / “1” time is counting down

Menu 2: Length of each half / period (1-99 minutes)

Set the first digit by using the arrows to change, press **ENTER** to confirm. Repeat for remaining digits.

Menu 3: Game clock stops or continues

Use the arrows to change whether the game clock stops when preset time for each half / period runs out** press **ENTER** to confirm.

“0” Continue counting / “1” Stop counting

Menu 4: Set suspension time for yellow card (1-99 minutes)

Available for specific models only

Set the first digit by using the arrows to change, press **ENTER** to confirm. Repeat for remaining digits.

Menu 5: Set ‘time of day’ clock

Only available for models with four digits for time

Set the first digit by using the arrows to change, press **ENTER** to confirm. Repeat for remaining digits.

Menu 6: Board time On/Off function *(Requires software v.3.30 or higher)*

Press **ENTER**. “0” will now be shown. Press **↑** until “1” is displayed and press **ENTER**. The board on time is now displayed. 07:00 is default. Edit the time as needed and press **ENTER**.

Now the board off time will be displayed. 22:00 is default. Edit the time as needed and press **ENTER**. Now the board on/off time has been set. Press the off button and then the daytime-button.

When the daytime-button is pressed after the board on/off time has been set, the time will be shown for 3 seconds and then turn off again, if daytime is not within the board on/off time.



Sådan virker din Naucon-10

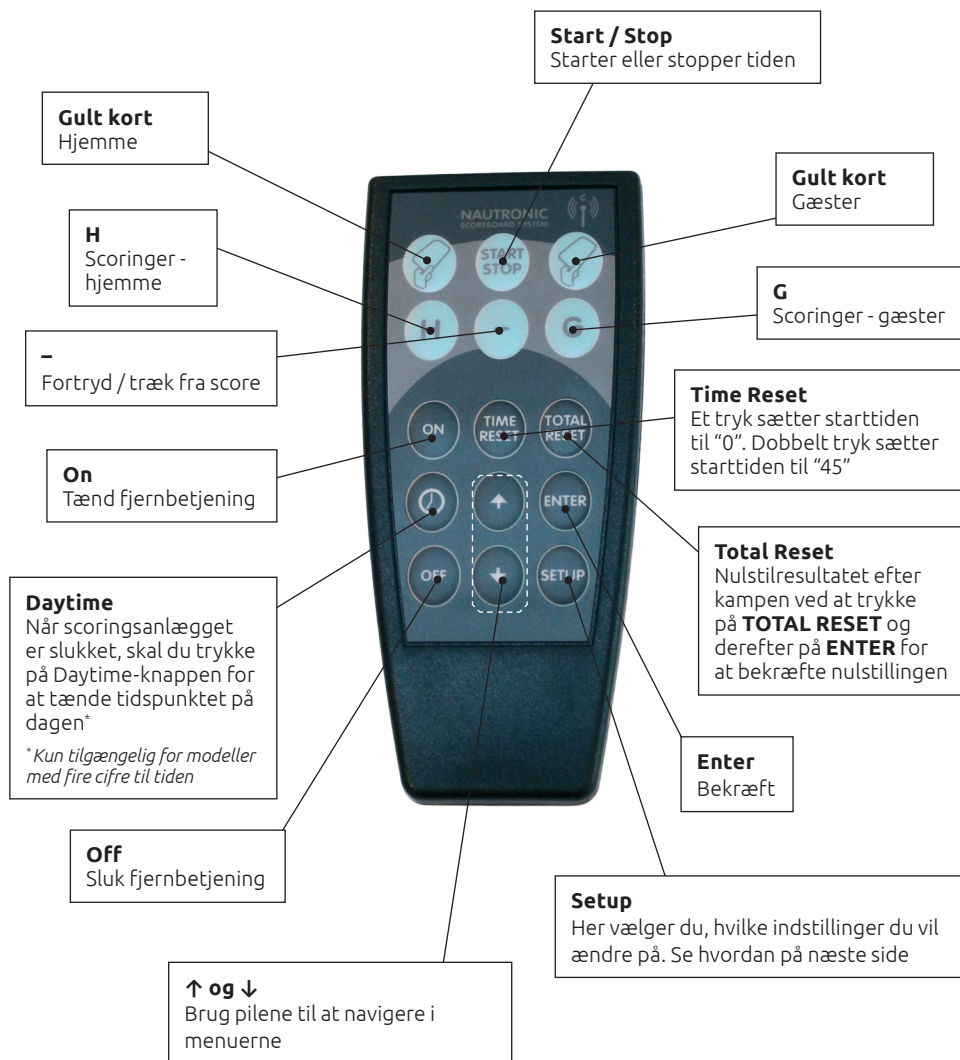

GENDAN FABRIKSINDSTILLINGER

Tryk to gange på **SETUP**. Scoringsanlægget viser cifterne som "8". Tryk **ENTER** for at bekræfte gendannelse af fabriksindstillingerne - eller tryk på hvilken som helst anden knap for at afbryde.



Funktionsmenuerne

Sådan bruger du funktionsmenuerne

Tryk **SETUP** og derefter **ENTER** for at gå til opsætning.

Vælg mellem 6 menuer; brug pilene til at navigere op og ned. Tryk **ENTER** for at bekræfte hvilken menu, du vil rette i.

Menu 1: Skal kamptiden tælle op eller ned

Brug pilene til at vælge om kamptiden skal tælle op eller ned*. Tryk **ENTER** for at bekræfte.

“0” kamptiden tæller op / “1” kamptiden tæller ned

Menu 2: Længden af halvleg (1-99 minutter)

Brug pilene til at ændre det første ciffer, ved at trykke op eller ned. Tryk **ENTER** for at bekræfte. Gentag fremgangsmåde for alle cifre.

Menu 3: Stop eller fortsæt tiden ved endt halvleg

Brug pilene til at vælge om tiden stopper eller fortsætter ved endt halvleg**. Tryk **ENTER** for at bekræfte.

“0” fortsæt tiden / “1” stop tiden

Menu 4: Længden af udvisning ved gult kort (1-99 minutter)

Kun tilgængelig for visse modeller

Brug pilene til at ændre det første ciffer, ved at trykke op eller ned. Tryk **ENTER** for at bekræfte. Gentag fremgangsmåde for alle cifre.

Menu 5: Indstil ur

Kun tilgængelig for modeller med fire cifre til tid

Brug pilene til at ændre det første ciffer, ved at trykke op eller ned. Tryk **ENTER** for at bekræfte. Gentag fremgangsmåde for alle cifre.

Menu 6: Board Time On/Off funktion *(Kræver software v.3.30 eller højere)*

Tryk **ENTER**. “0” vises nu. Tryk på ↑ indtil “1” vises, og tryk på **ENTER**. Board Time On vises nu. 07:00 er standard. Rediger tiden efter behov, og tryk **ENTER**.

Nu vil Board Time Off blive vist. 22:00 er standard. Rediger tiden efter behov, og tryk **ENTER**. Nu er tavlen på On/Off tid indstillet. Tryk på knappen Off og derefter på Daytime-knappen.

Når Daytime-knappen trykkes, efter Board Time On/Off er indstillet, vises tiden i 3 sekunder og slukker derefter igen, hvis tiden ikke er indenfor Board Time On/Off

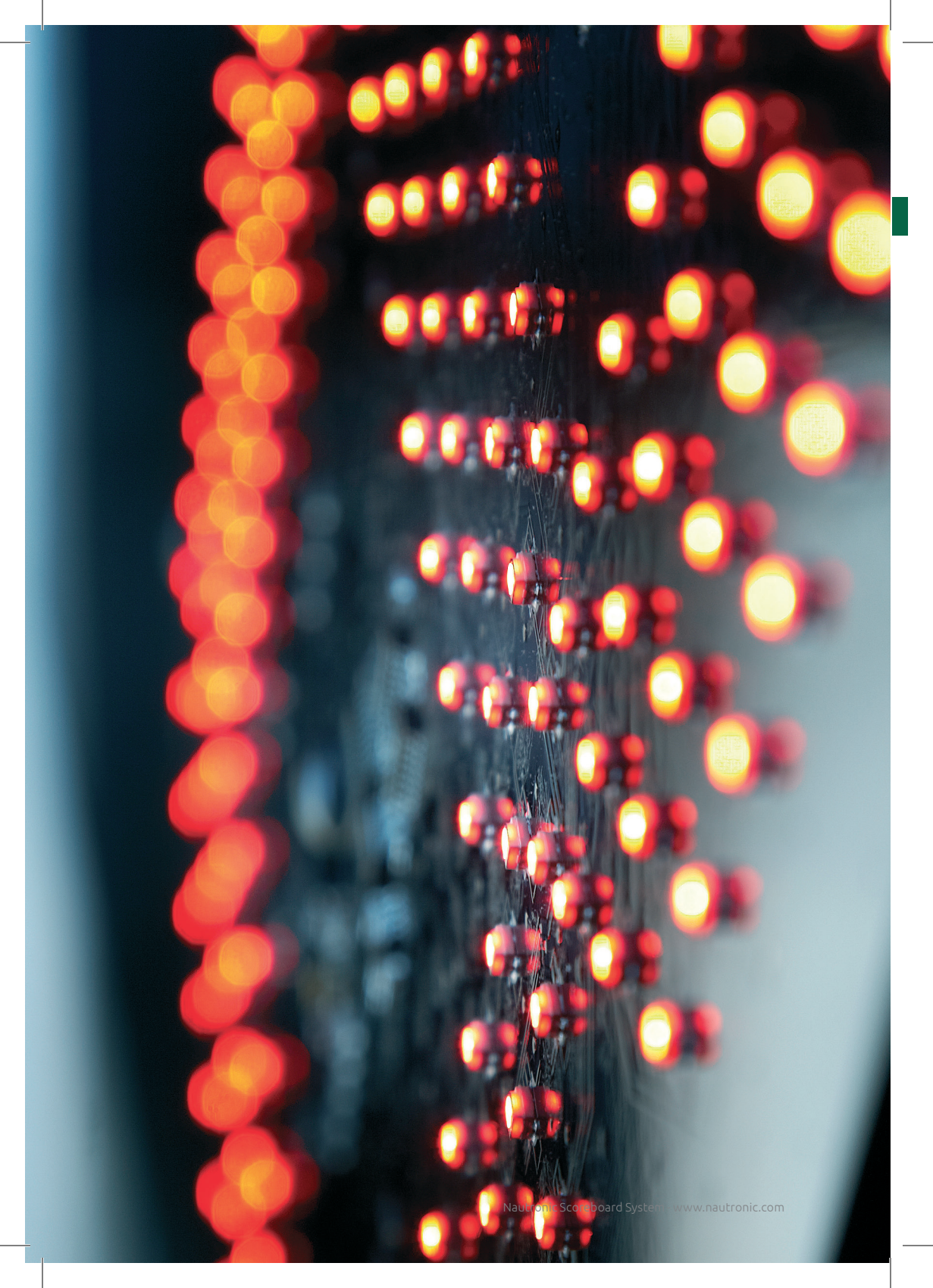



Troubleshooting

For more information on troubleshooting and service visit nautronic.com/spareparts/naucon-1000-service

The LED's indicates the following, when a Scoreboard is OK:

D1, D2, D3, D4 and D5 constantly light green. D6 flashes red. D7 flashes yellow. D8 flashes red, but only if a radio module is present.

4.1.1 D1, Main

If D1 is OFF: Check 230VAC Power for the scoreboard.

4.1.2 D2, 230VAC LED

If D2 is OFF: Check fuse F3.

4.1.3 D3, 12VDC Horn

If D3 is OFF: Check fuse F1.

4.1.4 D4, 24VDC Digit

If D4 is OFF: Check fuse F2.

4.1.5 D5, 24VDC for J2, J3 and J4.

If D5 is OFF: Remove all equipment connected to J2, J3 and J4. If D5 turns on, some of the equipment may be damaged.

4.1.6 D6, Equipment communication.

If D6 is OFF: Check the Cable connected to the NT Control Panel. Check the Wall connector.

4.1.7 D7, Internal Communication.

If D7 is OFF: Internal units in the Scoreboard might be damaged.

4.1.8 D8, Wireless Communication .

If D8 is OFF: Wireless module must be installed for D8 to function. Check that the NT Control Panel is turned ON.

4.2 NT Control Panel.

If the Power LED ON:

If wired connect NT Control Panel to the Scoreboard. If wireless, turn the NT Control Panel on. If the NT Control Panel does not respond and the Displays do not show text, the NT Control Panel is damaged and must be sent to repair.

Power LED OFF:

NT Control Panel - Cabled: Check the Cable connected between the Scoreboard system and the NT Control Panel. Check the Wall connector.

NT Control Panel - Wireless:

Exchange the battery charger. Let the wireless NT Control Panel charge for approximately 30 minutes.

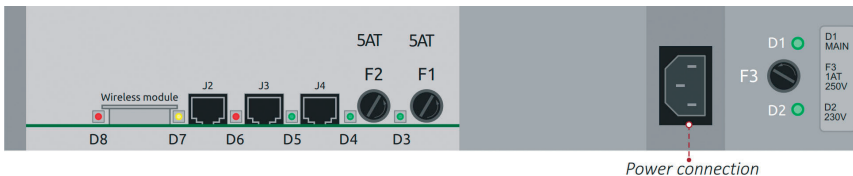

Seen from the bottom of the Scoreboard.